

Detail – Sandwiched CLT Panels – Glulam Beam Supported CLT Floor and Glulam Column Intermediate Support Section

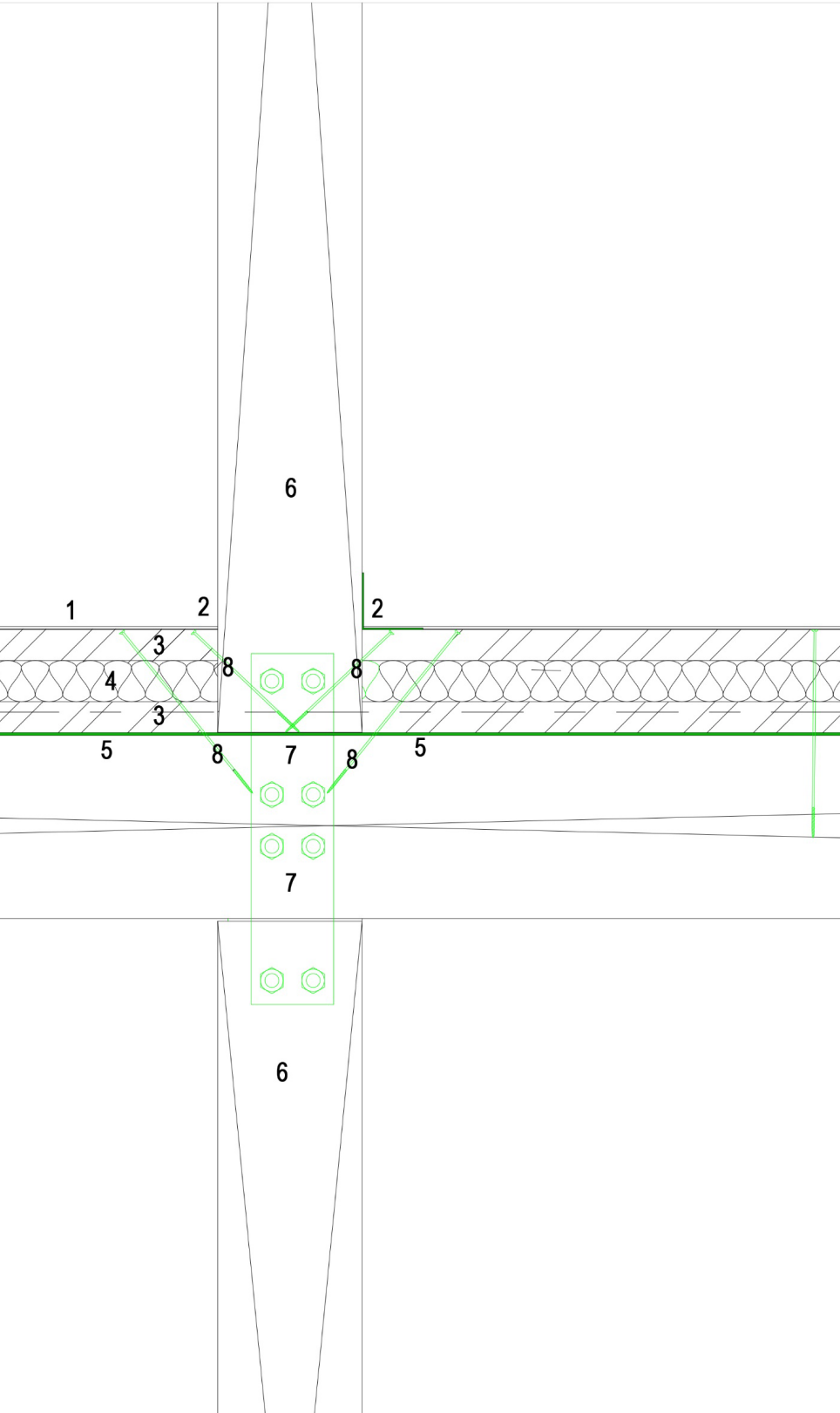

1. Stone Effect Grey Engineered Stone Flooring (Tenacity Tile). PVC free and plasticizer free ceramic composite (magnesium) made to be rigid, strong, unaffected by heat and temperature variations, and sustainable. Flooring Edges- Bevelled, Flooring Fitting Type- Click Fit, Flooring Format- Tile, Flooring Surface- Stone. Colour Description- Grey, Light grey, Commercial Suitability- Class 33 Heavy Commercial, Finish- Matt, Non-Lacquered, Material- 98% Mineral Compound, Pack Size- 12, Product Type- Engineered Stone, Thermal resistance - 0.15(m²K)/W. Length- 596mm, Width- 298mm, Thickness- 7mm, Abrasion Class- AC4- medium commercial use, Effect of Caster Chairs- Pas25,000R, Impact resistance >1800m, Light Fastness >Grade 6, TriTec Ultimate Surface, Mould, fire & smoke resistant, Similar stability, scratch, stain resistance as a ceramic tile Backing made from recycled plastic bottles pre-attached (500 ft² / 50 m² = 550 bottles recycled).

2. Full-surface self-adhesive Hanno Flashing Tape DUO Easy 180 is a full-surface adhesive flashing tape for interior and exterior seals, consisting of a modified polyamide-film/woven material combination. It is equipped with a full-surface self-adhesive side for connecting to windows and masonry as a standard feature. The cover film is cut in the longitudinal direction. Durability: optimal moisture management in the joint: sd value 0.6 :5 sd :5 23 m, Resistance to driving rain >600 Pa, Airtight to around :5 0.1 m³/(h·m ·(daPa)²/3), No additional film adhesive required, All bonded layers covered with longitudinally cut film, Stretchy and simple to work with, Can be plastered or painted over, UV-resistant for 12 months.

3. 60mm MM cross-laminated timber panels, spruce, European Technical Approval ETA-09/0036, improved fire rating- water based fire retardant treated, off-site pre-assembled and pre-insulated 4 sandwich panels per roof/floor. thermal conductivity: 0.13 W /mK, density: 480-500 kg/m³, Compressive strength: 2.5 N/mm² (perpen. to grain of boards) 21 N/mm² (parallel to grain of boards), Bending strength: 24 N/mm² (parallel to grain of boards), Elastic modulus: 370 N/mm² (perpen. to grain of boards) 11,500 N/mm² (parallel to grain of boards)

4. 80mm PUR expanding foam insulation, ISOTHANE LD40, CFC & HCFC FREE, density 40 kg/m³, water and air tight, fire resistant, U-value 0.025W/mK

5. Monarfloor Wall Cap 100 Timber- 3.8mm x 100mm x 8m- Bitumen composite membrane with acoustically rated fillers and a fire retardant finish

6. Glulam column 240x240 and beam 240x360, Stress Grade: GL32 c (BS16) with combined layup, min three fibre parallel oriented glued board laminations, wood species European Spruce (picea app.) and Larch. Wood moisture content 12% ± 2% at delivery. Gluing: Waterproofed adhesives approved for interior and exterior applications, tested in accordance with EN 301/302. Lamination thickness: According to EN 386-up to 42mm max. Glulam members coated with a base preservative.

7. Shear plates: two plates per one connection (front and back). Sized 110x580mm, thickness t 10mm, ASTM A36, with drilled holes for bolting 8 x 22 mm diameter in four rows. Bolts M12/M16 8.8 in 22 mm diameter holes. Minimum of two M16 grade bolts used per connection. All bolts sherardized.

8. HBS 8x320 screws