

Typical Detail – Cavity Wall to Cold Timber Roof

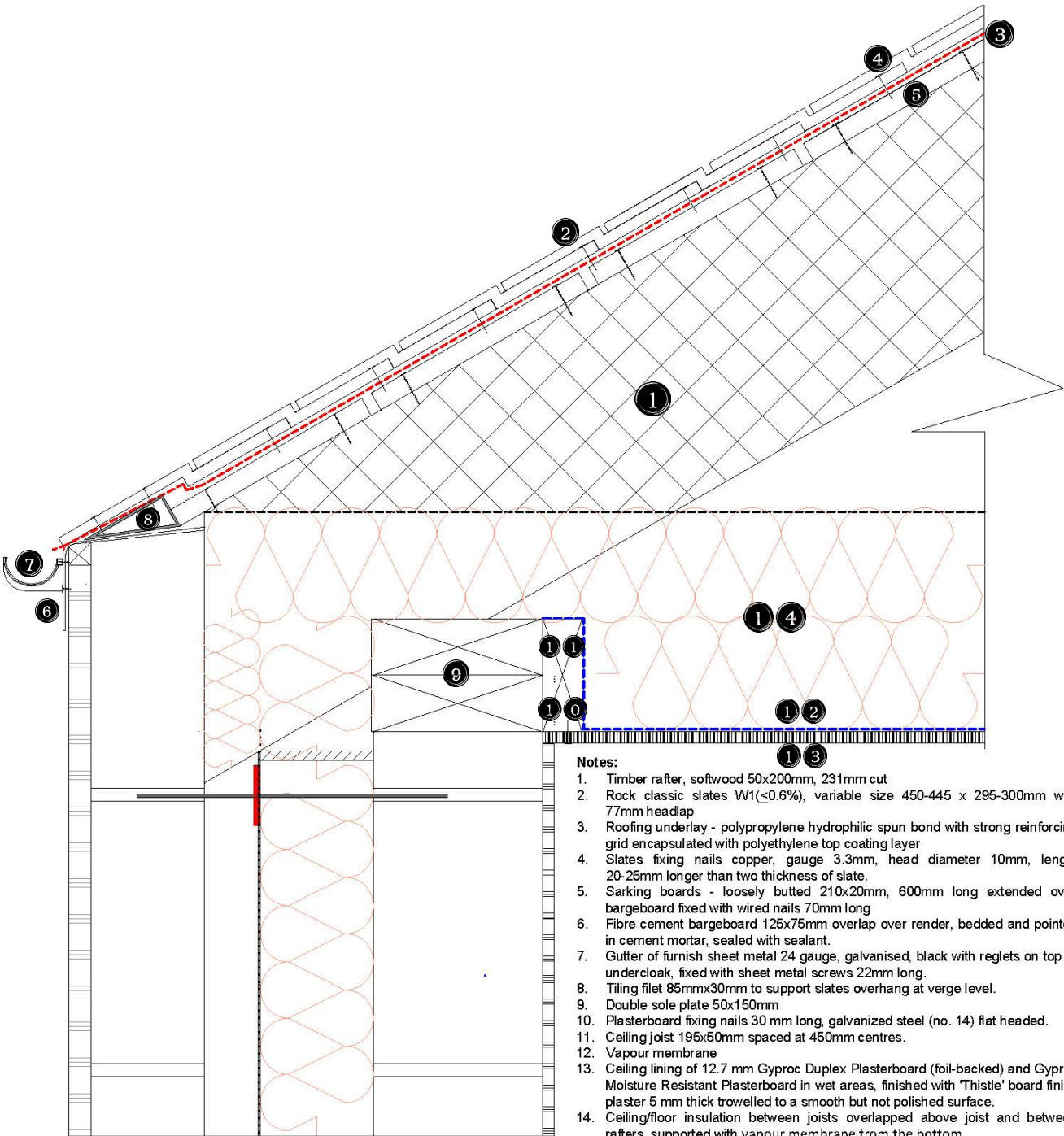

Notes:

1. Timber rafter, softwood 50x200mm, 231mm cut
2. Rock classic slates W1(≤0.6%), variable size 450-445 x 295-300mm with 77mm headlap
3. Roofing underlay - polypropylene hydrophilic spun bond with strong reinforcing grid encapsulated with polyethylene top coating layer
4. Slates fixing nails copper, gauge 3.3mm, head diameter 10mm, length 20-25mm longer than two thickness of slate.
5. Sarking boards - loosely butted 210x20mm, 600mm long extended over bargeboard fixed with wired nails 70mm long
6. Fibre cement bargeboard 125x75mm overlap over render, bedded and pointed in cement mortar, sealed with sealant.
7. Gutter of furnish sheet metal 24 gauge, galvanised, black with reglets on top of undercloak, fixed with sheet metal screws 22mm long.
8. Tiling file 85mmx30mm to support slates overhang at verge level.
9. Double sole plate 50x150mm
10. Plasterboard fixing nails 30 mm long, galvanized steel (no. 14) flat headed.
11. Ceiling joist 195x50mm spaced at 450mm centres.
12. Vapour membrane
13. Ceiling lining of 12.7 mm Gyproc Duplex Plasterboard (foil-backed) and Gyproc Moisture Resistant Plasterboard in wet areas, finished with 'Thistle' board finish plaster 5 mm thick trowelled to a smooth but not polished surface.
14. Ceiling/floor insulation between joists overlapped above joist and between rafters, supported with vapour membrane from the bottom