

# Typical Detail – Light Steel Framing – Roof and Eave Fixing

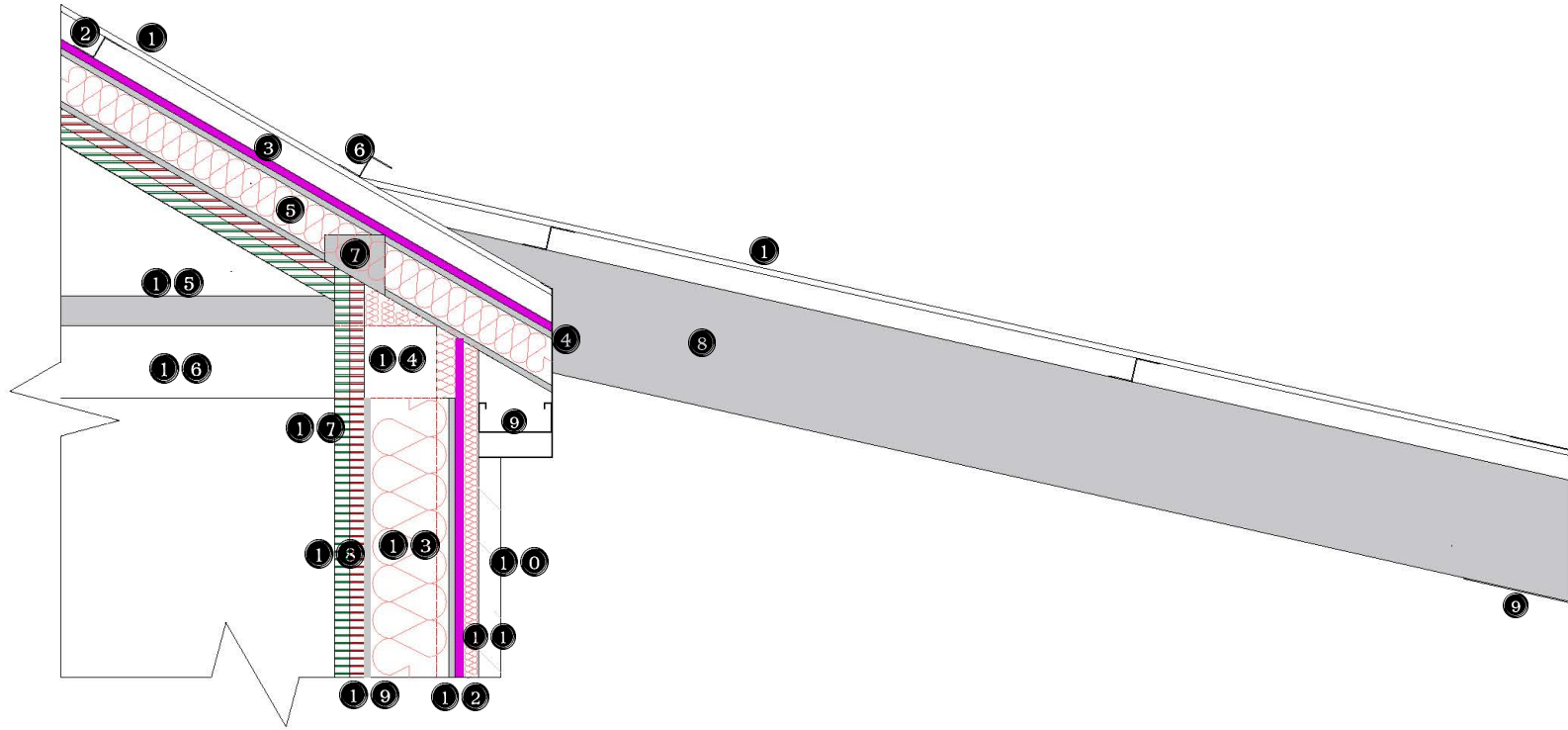

## Notes:

1. Galvanized steel profiled sheets with standard zinc coating (g/m<sup>2</sup>) 275 (Z275), type PS L 19/1000 with Anti-Condensation Membrane backing, profile thickness 0.7mm, coated BSC Colorcoat HP 200 plastisol - Anthracite RAL 7016, sized 1000 mm width x 3112mm length, 1000mm x 1750mm for overhang
2. Roof cladding support: Zed 40 x 40 x 40 x 3000 length, gauge 2.0 mm.
3. Roof External Weather Defence sarking boards, Sheathing board(s) layer 1 x 12.5mm, Sizes: Width: 1200mm, Length: 2400mm
4. C studs C.100.50.12 depth (Dmm) 100, flange (Wmm) 50, return (Rmm) 10, gauge (Tmm) 1.2, weight (kg/m) 2.02.
5. Earthwool® OmniFit Slab - Multi-purpose, non-combustible, glass mineral wool slab for installation by friction fitting. Thickness 75mm.
6. Roof maintenance safety support: Zed 40 x 40 x 40 x 3000 length, gauge 2.0 mm.
7. Bracing Straps 100 width gauge 1.2, 90% angled.
8. C studs C.200.50.12 depth (Dmm) 200, flange (Wmm) 50, return (Rmm) 10, gauge (Tmm) 1.2, weight (kg/m) 2.96.
9. Eaves barge boards - galvanized steel 0.7mm gauge flashings folded to the internal angles, Standard zinc coating (g/m<sup>2</sup>) 275 (Z275) and coated BSC Colorcoat HP 200 plastisol - Anthracite RAL 7016 with Deflection Bracket DHB150 gauge 1.2
10. External wall cladding: horizontal Siberian Larch timber boards sized 145mm width up to 6000mm long, profile - open rainscreen with Secret-fix solution, 37mm deep.
11. Thermawall TW55 PIR Insulation Board, Thickness: 25mm, Width: 1200mm, Length: 2400mm,
12. Wall External Weather Defence sarking boards, Sheathing board(s) layer 1 x 12.5mm, Sizes: Width: 1200mm, Length: 2400mm
13. Earthwool® OmniFit Stud - Multi-purpose, non-combustible, glass mineral wool roll for installation by friction fitting. Thickness 130mm.
14. Hollow cold formed square supportive posts 120x120 Designation thickness t 10mm, ASTM A36
15. Loadbearing U track section U.154.50.12 depth (Dmm) 150, flange (Wmm) 50, B Fl (Arm) 50, gauge (Tmm) 1.2, weight (kg/m) 2.39
16. Hollow beams cold formed squares 120x120 Designation thickness t 10mm, ASTM A36 (top plate).
17. 1 x 15mm GTEC MegadecoVBoard vapour control plasterboard
18. 1 x 15mm GTEC Megadeco dense plasterboard with superior fire resistance, sound insulation and impact resistance.
19. Loadbearing wall C stud C.150.50.12 depth (Dmm) 150, flange (Wmm) 50, return (Rmm) 10, gauge (Tmm) 1.2, weight (kg/m) 2.49.